

DISCLAIMER STATEMENT

*Unless expressly specified otherwise, all capitalized terms used in this disclaimer statement (this **Disclaimer Statement**) shall bear the meaning ascribed thereto in the 'REQUEST FOR PROPOSAL' (consisting of **VOLUME I (TENDER PROCEDURE)**, **VOLUME II (TECHNICAL SPECIFICATIONS)** and **VOLUME III (CONCESSION AGREEMENT)**) dated August 16, 2024 (as amended, supplemented and modified through subsequent response to Bidders' queries documents and addenda to the RFP) (the **RFP Documents**).*

This Disclaimer Statement is being issued by KWSC in relation to the Project. Further to the request of various Interested Parties during the Pre-Bid Meeting dated September 4, 2024, KWSC has elected to provide the following technical studies (collectively, the **Technical Studies**) conducted by the technical advisors for the Project on behalf of KWSC:

1. Bathymetric Study;
2. Climatic Data;
3. Geotechnical Investigation Report;
4. Seawater Intake Drawings;
5. Geography & Topography Survey;
6. Water Sample Report; and
7. Environmental Impact Assessment Report

No GoS Party makes any representations (express or implied) or warranties as to the accuracy or completeness of the information contained in the Technical Studies, or in any other document or information made available to a person in connection with the Project (including the Tender Procedure); and the same shall have no liability for the Technical Studies or for any other written or oral communication transmitted to the recipient in the course of the recipient's evaluation of the Project. No GoS Party shall be liable to reimburse or compensate any recipient for any costs, fees, damages or expenses incurred by the recipient in evaluating or acting upon the Technical Studies or otherwise in connection with the Project.

KWSC has made available the Technical Studies to the Interested Parties solely for the purpose of enabling them to prepare and submit Bids in response to the RFP. The Technical Studies are for reference purposes only and are not to be construed as a representation or warranty of any kind, express or implied, regarding their accuracy, completeness, or reliability.

Each Interested Party is responsible for conducting its own independent investigation, due diligence, and verification of all aspects of the RFP and the Technical Studies, including any assumptions, projections, and conclusions. The GoS Parties shall have no liability or responsibility for any reliance placed on the Technical Studies or for any errors, inaccuracies, or omissions therein.

KWSC reserves the right to amend, supplement, or withdraw any part of the Technical Studies at any time without notice. The provision of Technical Studies does not obligate KWSC to provide any updates, corrections, or additional information, nor does it create any obligation for KWSC to enter into any agreement or contract with any Interested Parties.

To the fullest extent permitted by Law, the GoS Parties shall not be liable for any loss, damage, or expense incurred by any Interested Parties or any other person arising out of or in connection with the use of or reliance on the Technical Studies, including but not limited to any inaccuracies, errors, or omissions contained therein.

By accessing the Technical Studies, the Interested Parties acknowledge and accept this Disclaimer Statement by the act of using and relying upon the Technical Studies.

This Disclaimer Statement is to be read in conjunction with, and forms part of, the RFP Documents.

"5 MGD DESALINATION PLANT AT IBRAHIM HYDERI"

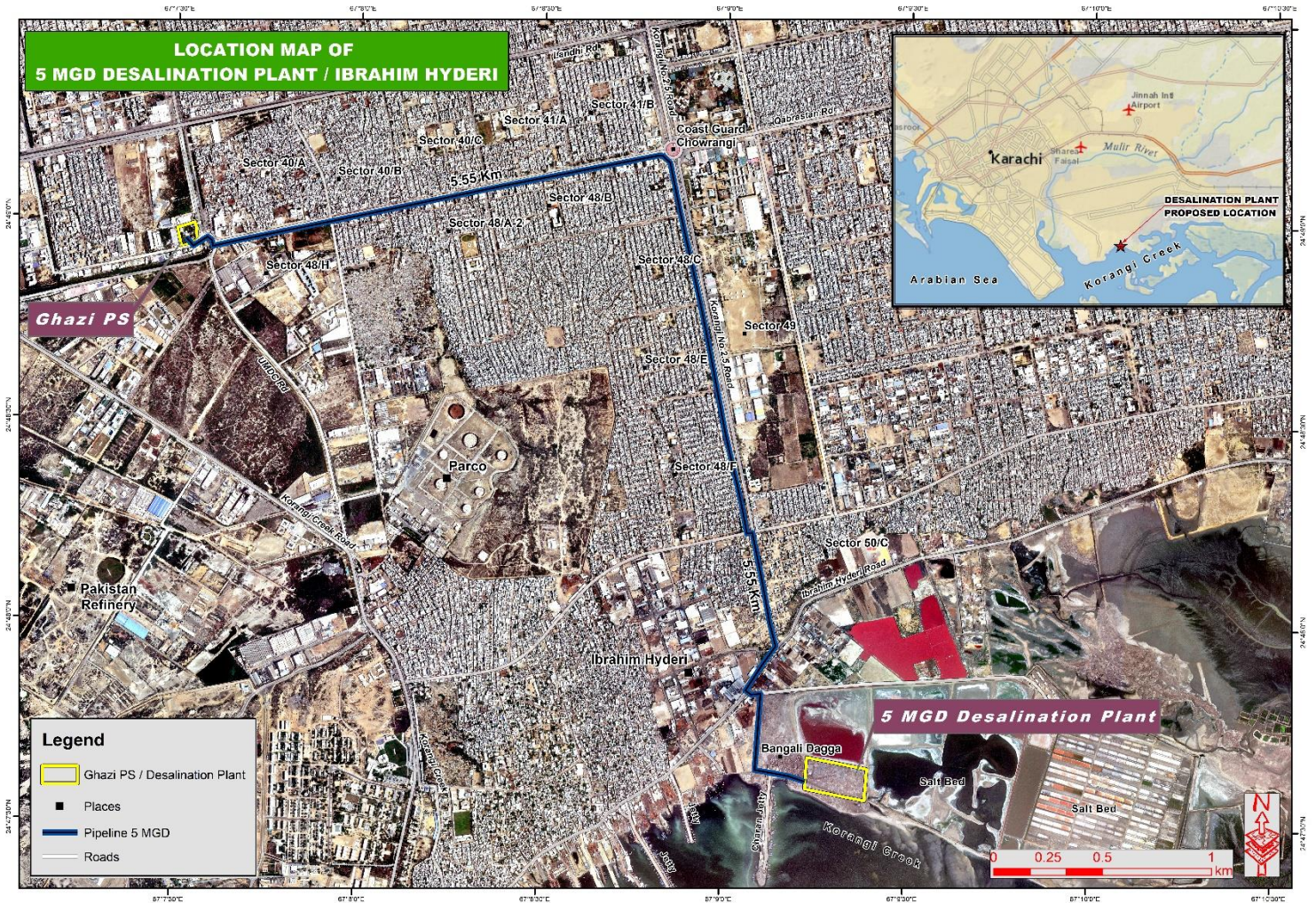

SEA WATER INTAKE DRAWINGS With LAB REPORTS OF SEA BED

Karachi Water & Sewerage Board (KW&SB).

SOILMAT ENGINEERS

B-136, Block-1, Opp. N.E.D. University, Main University Road, Gulistan-e-Jauhar,
Karachi. Ph: 34623161-2, 35458647, Fax: 34632483
E-mail: soilmatengineers@yahoo.com



CLIENT:
SOURCE:
LAB. NO:

M/s Techno Consult International
Sea Bed
58389

DATE: 16/09/2022

PARTICLE SIZE ANALYSIS OF SOIL (ASTM D-422)

S.No.	SAMPLE	PERCENTAGE OF PASSING										HYDROMETER ANALYSIS			
		3/8"	#4	#8	#10	#16	#30	#40	#50	#100	#200	0.05mm	0.01mm	0.005mm	0.002mm
1	Grab-01 Depth: Sampling Date: 31/08/22	-	-	-	100	96.3	95.3	93.5	93.0	89.8	84.7	70.5	37.2	23.1	18.1
2	Grab-04 Depth: 2.8m Sampling Date: 31/08/22	-	-	-	-	100	99.5	98.4	-	96.8	93.4	82.5	30.0	24.0	19.1
3	Grab-07 Depth: 3.20m Sampling Date: 31/08/22	-	-	-	100	99.0	98.2	96.0	95.8	87.2	70.7	62.0	20.2	12.5	9.0
4	Grab-08 Depth: 4.0m Sampling Date: 31/08/22	-	-	-	-	100	99.7		99.3	98.3	94.3	90.1	38.1	30.2	25

Note: The above test results pertain to the sample supplied by the client.

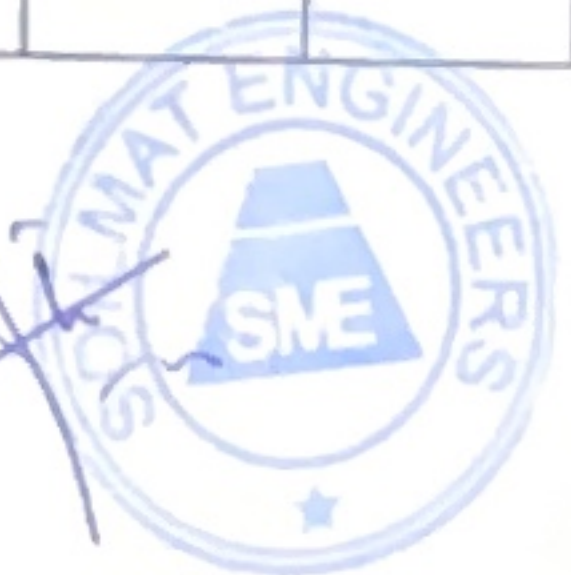

SOILMAT ENGINEERS

B-136, Block-1, Opp. N.E.D. University, Main University Road, Gulistan-e-Jauhar,
Karachi. Ph: 34623161-2, 35458647, Fax: 34632483
E-mail: soilmatengineers@yahoo.com



CLIENT: M/s Techno Consult International
SOURCE: Sea Bed
LAB. NO: 58389

DATE: 23/09/2022

LABORATORY TEST RESULT AASHTO T-267

S.NO.	SAMPLE MARK	ORGANIC MATTER CONTENT %
-------	-------------	--------------------------

1

Grab-1
Depth:
Sampling Date: 31/08/22

7.95

NOTE: The above test results pertain to the sample supplied by the client.

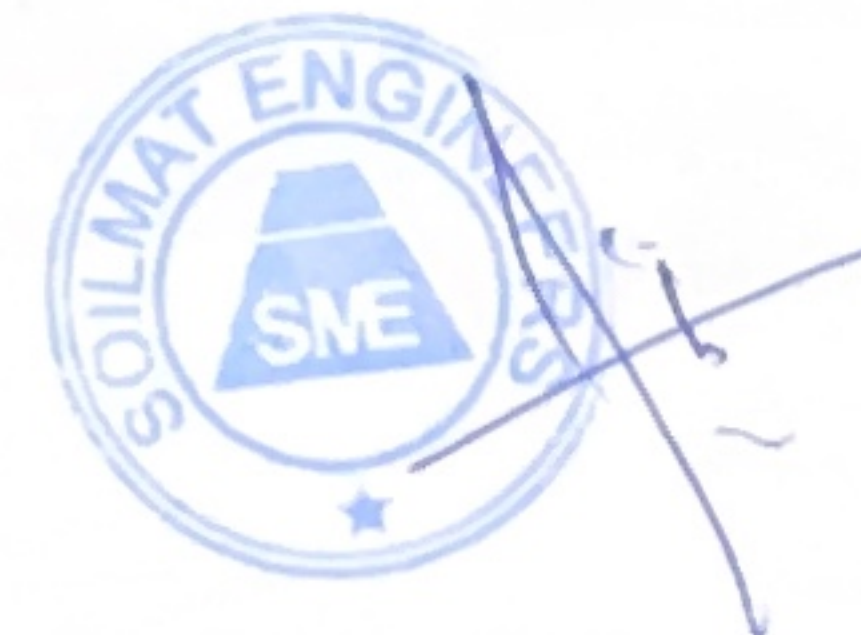

SOILMAT ENGINEERS

B-136, Block-1, Opp. N.E.D. University, Main University Road, Gulistan-e-Jauhar,
Karachi. Ph: 34623161-2, 35458647, Fax: 34632483
E-mail: soilmatengineers@yahoo.com



CLIENT: M/s Techno Consult International
SOURCE: Sea Bed
LAB. NO: 58389

DATE: 23/09/2022

LABORATORY TEST RESULT AASHTO T-267

S.NO.	SAMPLE MARK	ORGANIC MATTER CONTENT %
-------	-------------	--------------------------

1

Grab-4
Depth: 2.8m
Sampling Date: 31/08/22

7.39

NOTE: The above test results pertain to the sample supplied by the client.



SOILMAT ENGINEERS

B-136, Block-1, Opp. N.E.D. University, Main University Road, Gulistan-e-Jauhar,
Karachi. Ph: 34623161-2, 35458647, Fax: 34632483
E-mail: soilmatengineers@yahoo.com



CLIENT: M/s Techno Consult International
SOURCE: Sea Bed
LAB. NO: 58389

DATE: 23/09/2022

LABORATORY TEST RESULT

AASHTO T-267

S.NO.	SAMPLE MARK	ORGANIC MATTER CONTENT %
-------	-------------	--------------------------

1

Grab-7
Depth: 3.20m
Sampling Date: 31/08/22

7.951

NOTE: The above test results pertain to the sample supplied by the client.



SOILMAT ENGINEERS

B-136, Block-1, Opp. N.E.D. University, Main University Road, Gulistan-e-Jauhar,
Karachi. Ph: 34623161-2, 35458647, Fax: 34632483
E-mail: soilmatengineers@yahoo.com



CLIENT: M/s Techno Consult International
SOURCE: Sea Bed
LAB. NO: 58389

DATE: 23/09/2022

LABORATORY TEST RESULT AASHTO T-267

S.NO.	SAMPLE MARK	ORGANIC MATTER CONTENT %
-------	-------------	--------------------------

1

Grab-8
Depth: 4.0m
Sampling Date: 31/08/22

8.31

NOTE: The above test results pertain to the sample supplied by the client.



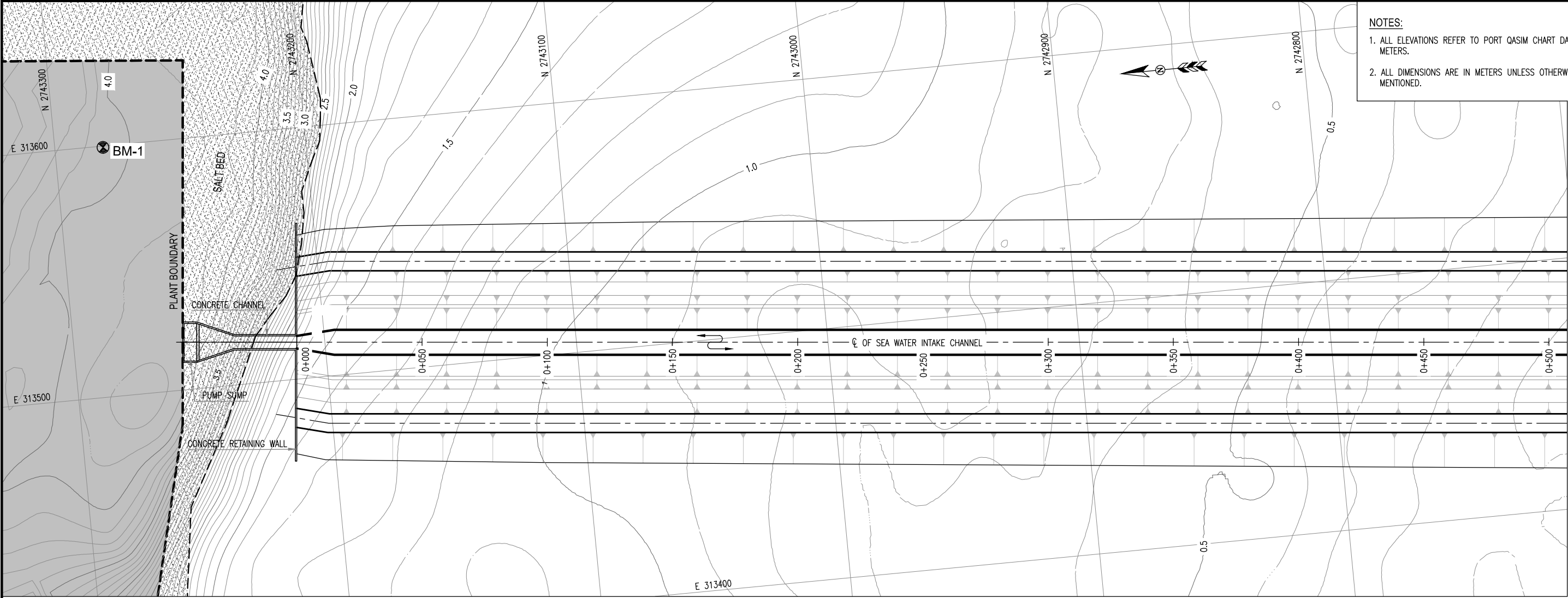

- NOTES:**
1. ALL ELEVATIONS REFER TO PORT QASIM CHART DATUM IN METERS.
 2. ALL DIMENSIONS ARE IN METERS UNLESS OTHERWISE MENTIONED.

PLAN

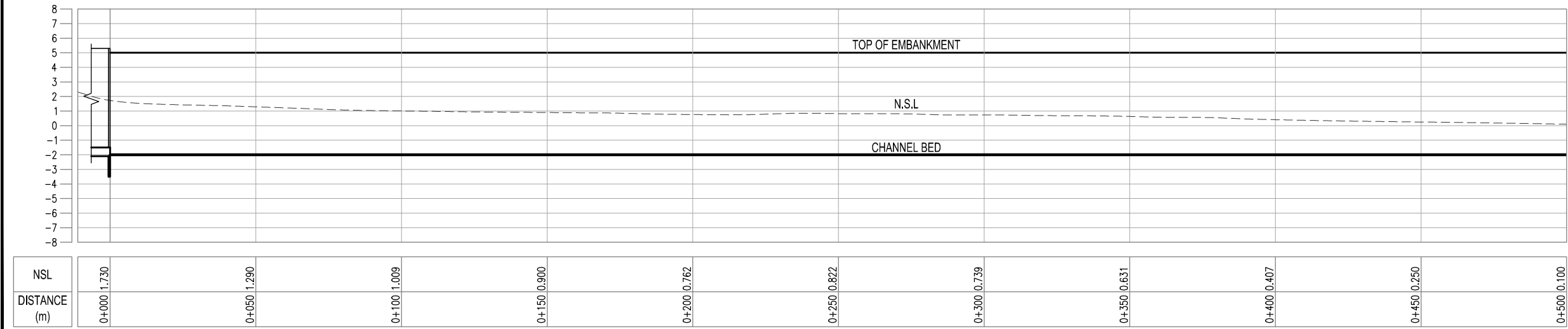
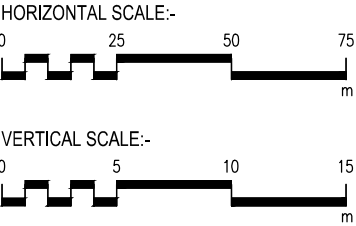

LONGITUDINAL SECTION

0			
No.	Revision	By	Date
Client :			
Project :			
5 MGD DESALINATION PLANT			
Consultants :			
Drawing Title :			
SEA WATER INTAKE CHANNEL PLAN & PROFILE STATION: 0+000 TO 0+500 (SHEET 1 OF 3)			
Designed By : JA	Date : SEPTEMBER 2022		
Drawn By : AR	Scale : AS SHOWN		
Checked By : JA	Drg No : 000	Revision	
Approved By : MBL		0	

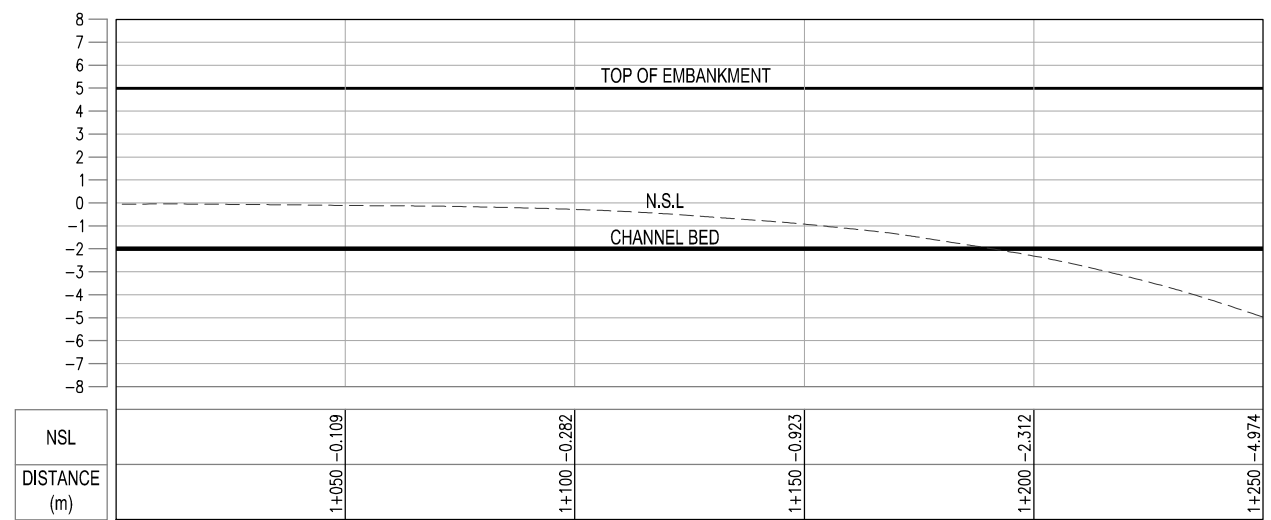
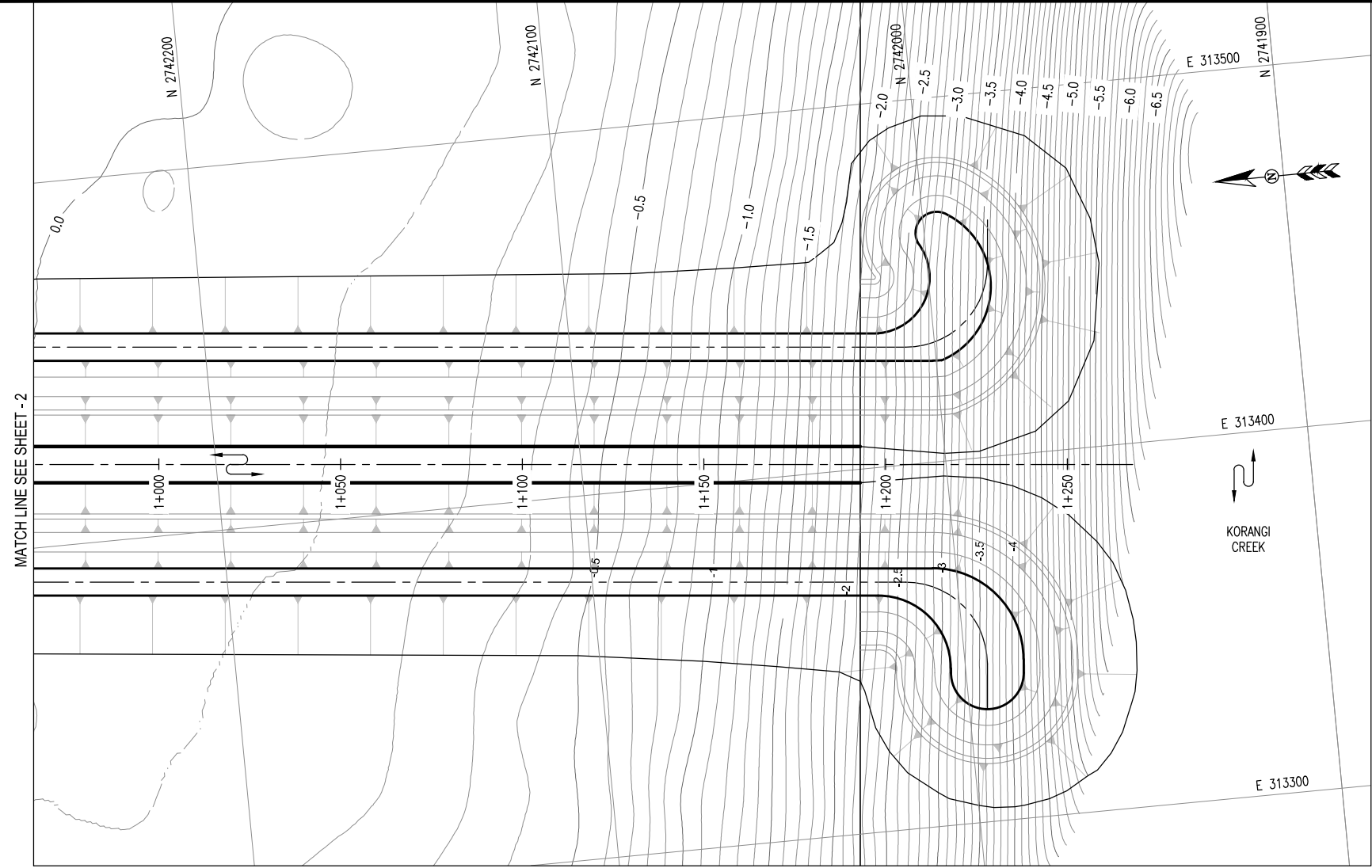

- NOTES:
1. ALL ELEVATIONS REFER TO PORT QASIM CHART DATUM IN METERS.
 2. ALL DIMENSIONS ARE IN METERS UNLESS OTHERWISE MENTIONED.

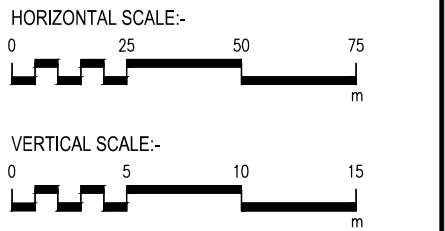

0			
No.	Revision	By	Date
Client :			

Project :			
5 MGD DESALINATION PLANT			
Consultants :			
Drawing Title :			
SEA WATER INTAKE CHANNEL PLAN & PROFILE STATION: 1+000 TO 1+250 (SHEET 3 OF 3)			
Designed By : JA	Date : SEPTEMBER 2022		
Drawn By : AR	Scale : AS SHOWN		
Checked By : JA	Drg No : 000	Revision	
Approved By : MBL		0	

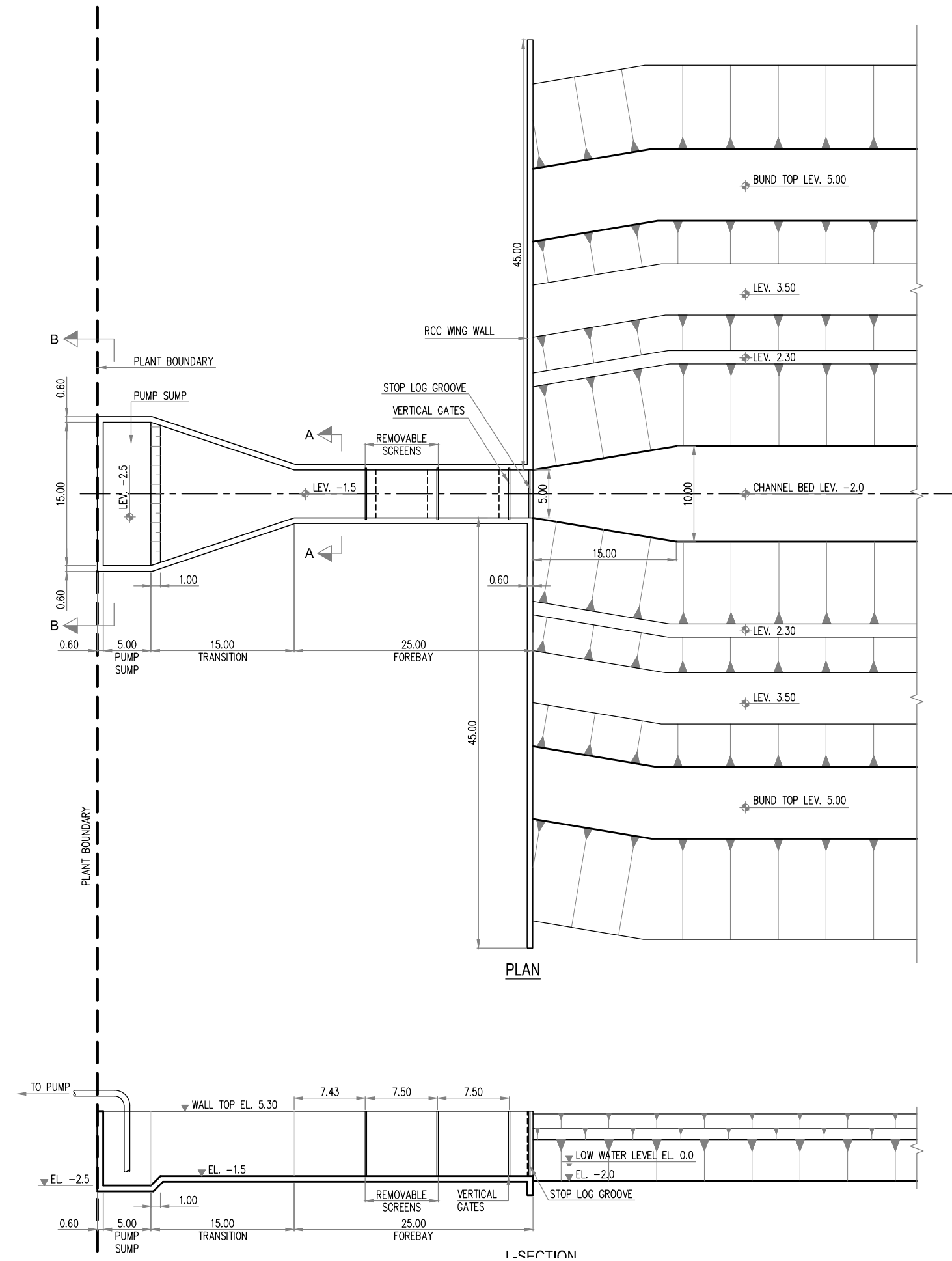

NOTES:

1. ALL ELEVATIONS REFER TO PORT QASIM CHART DATUM IN METERS.
2. ALL DIMENSIONS ARE IN METERS UNLESS OTHERWISE MENTIONED.
3. ALL CONCRETE SHALL BE PREPARED USING SULPHATE RESISTANT CEMENT.
4. ALL METAL WORK EXCEPT REINFORCING STEEL SHALL BE STAINLESS STEEL, ALUMINUM OR OTHER CORROSION PROOF SUBSTANCE.

SCALE:-

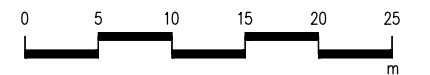

No.	Revision	By	Date
0			

Client :

Project :

5 MGD DESALINATION PLANT

Consultants :



Drawing Title :

**SEA WATER INTAKE CHANNEL
FOREBAY & PUMP SUMP DETAIL PLAN**

Designed By : JA	Date : SEPTEMBER 2022	
Drawn By : AR	Scale :	
Checked By : JA	Drg No : 000	Revision
Approved By : MBL		0

NOTES:

1. ALL ELEVATIONS REFER TO PORT QASIM CHART DATUM IN METERS.
2. ALL DIMENSIONS ARE IN METERS UNLESS OTHERWISE MENTIONED.

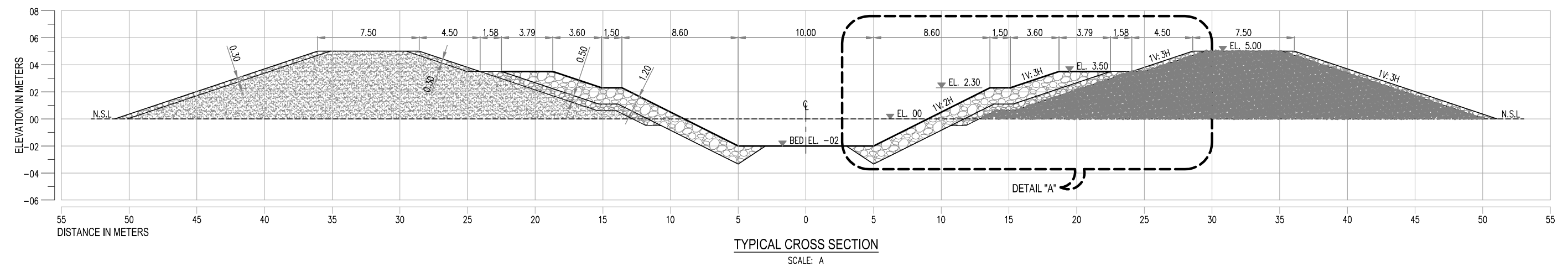

SCALE:- A



SCALE:- B



No.	Revision	By	Date
0			

Client :

Project :
5 MGD DESALINATION PLANT

Consultants :
 **Techno-Consult International**
(Pvt.) Ltd.

Drawing Title :
**SEA WATER INTAKE CHANNEL
TYPICAL CROSS SECTION**

Designed By : JA	Date : SEPTEMBER 2022	
Drawn By : AR	Scale :	
Checked By : JA	Drg No : 000	Revision
Approved By : MBL		0

